

PRELIMINARY INFORMATION

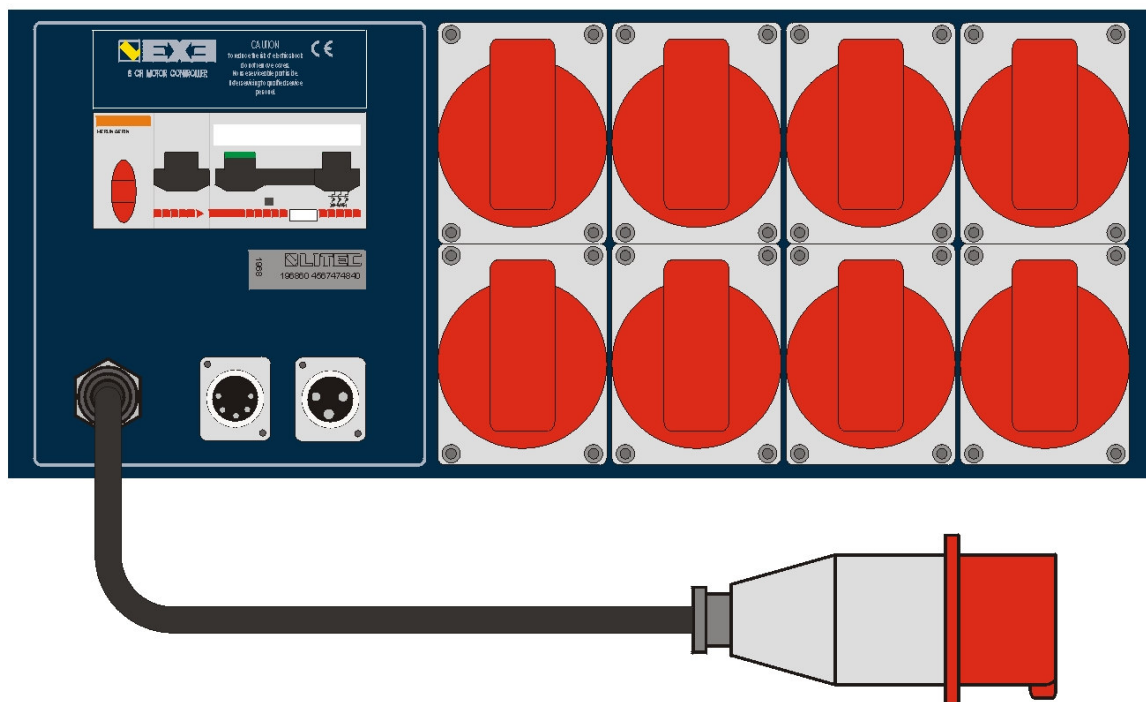
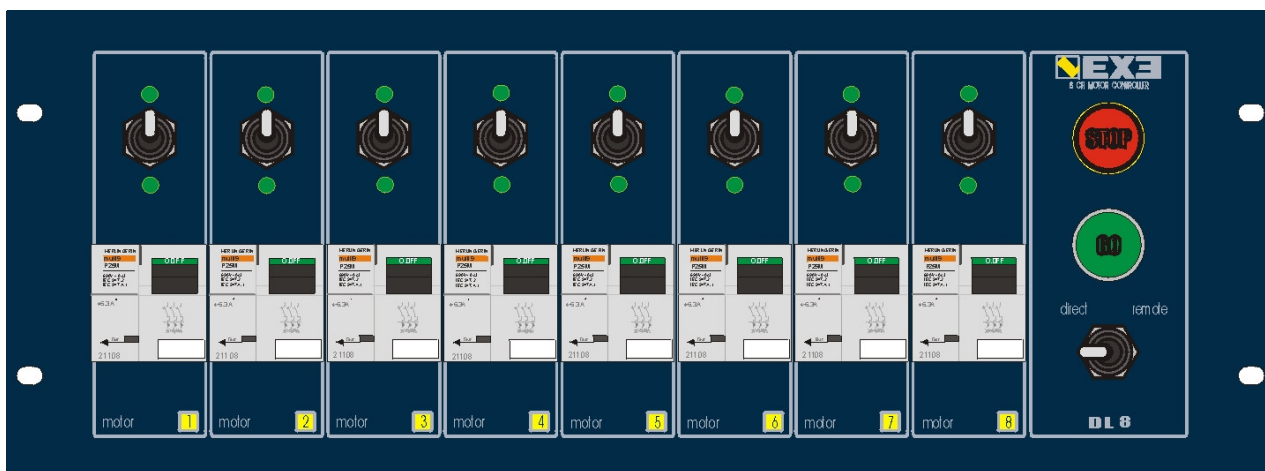

The DL8 is a manual motor controller which can work in Direct and Link mode. Link mode enables the use of additional controllers by means of a link cable. This choice of MODE permits the controllers to be linked one to another, with one becoming the Master controller and the remainder becoming Slaves. The choice of Link MODE must be effected in each individual machine. In LINK mode the Master controller manages the GO and STOP functions for all the Slave controllers to which is connected.

Description	Specification
Code	XC DL8
Number of channels	8
Control	Direct (400 – 415 V; 3 ph; 50 Hz)
Input power	1 CEE 32 A – 5p plug
Output	8 CEE 16 A – 4p plug
Protection	- Earth Break switch for power and control - Emergency STOP mushroom - Emergency Choke Coil
Remote	EXE hand control – “Go” only- (mod. DHG)
Function	Master/slave
Housing	19” 4UR
Functional Description	Direct Mode – Link Mode
Direct Mode	<ol style="list-style-type: none"> 1 – Connect the 32A 3 phase plug to the power supply 2 – Connect plugs to for the electric hoists concerned, to the appropriate sockets of the 16A 3 phase 4p 3 – Check that emergency STOP mushroom is not engaged 4 – Arm the Emergency Choke Coil 5 – Arm the Magneto Thermal switch 6 – Check that all 3 warning lights are illuminated 7 – Engage the gear lever corresponding to each motor, to the position required: UP, lever in upper position, DOWN, lever in lower position. 8 - Pushing the GO button will activate the motors to move simultaneously 9 – Releasing the GO button will cease the movement of the motors, simultaneously
Link Mode	<ol style="list-style-type: none"> 10 - Follow steps 1,2 & 3 of the Direct Mode operation, for each controller you wish to connect for use in Link mode. 11 - Establish which controller will be the Master and position the Mode switch to DIRECT Mode 12 - On each of the remaining controllers to be connected in Link mode, position the Mode switch at REMOTE. 13 - With the link cable provided, connect the Master Controller with the first Slave controller as follows: PIN 5 OUT - PIN 3 IN 14 - Connect all subsequent Slave controllers, using the link cables provided, as follows: PIN 5 OUT - PIN 3 IN 15 - Arm the Emergency Choke Coil on the Master controller. 16 - Arm the general Magneto Thermal switch of the Master controller 17 - Check that all 3 warning lights are illuminated 18 - Repeat steps 15,16 & 17 for all the Slave controllers 19 – Engage the gear lever corresponding to each motor, to the position required: UP, lever in upper position, DOWN, lever in lower position. 20 - Push the GO button on the Master controller and all the motors will move simultaneously 21 – Releasing the GO button will cease the movement of the motors, simultaneously